

This drawing is produced using the Irish Grid Geographic Coordinate System

A1

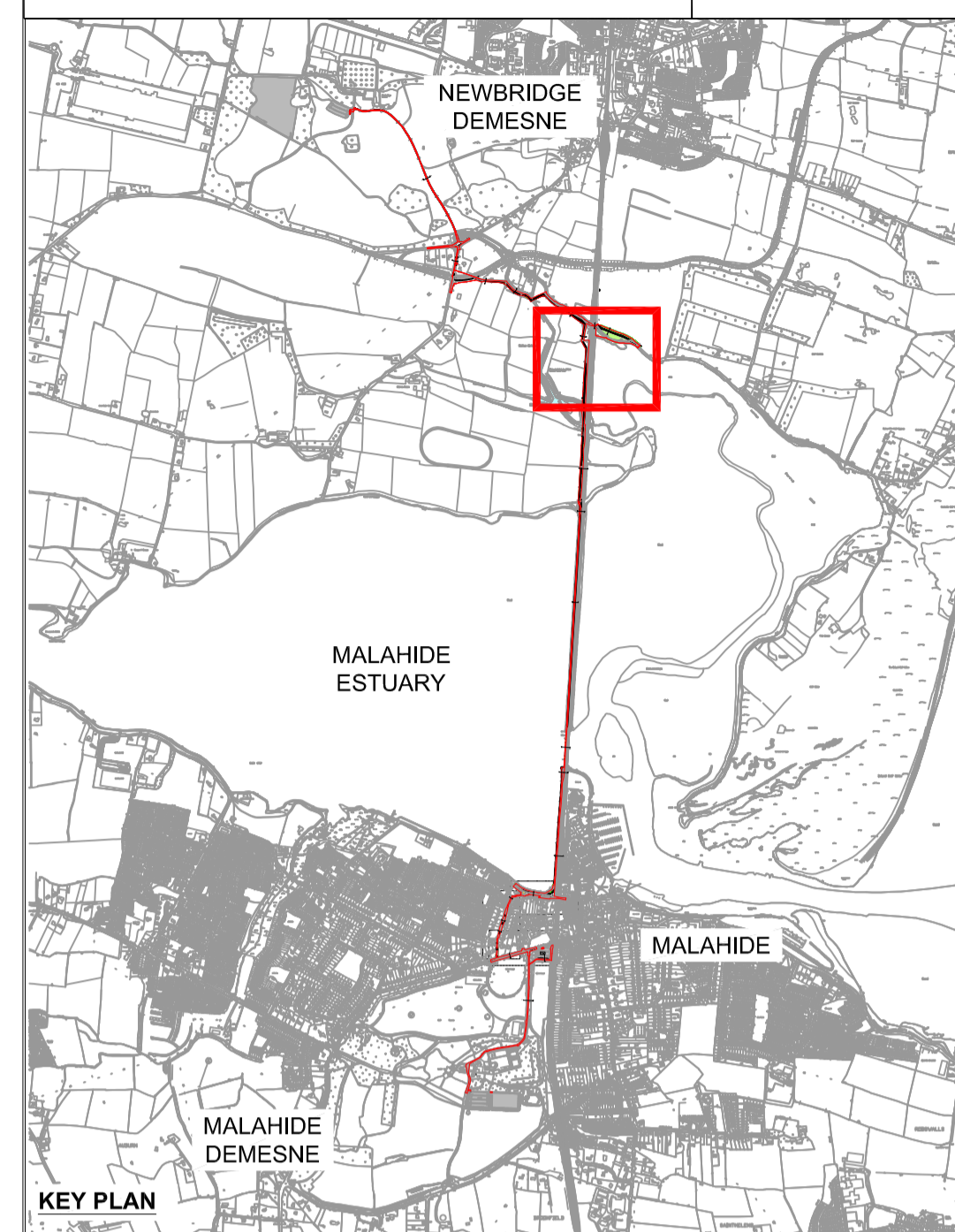

**LEGEND:**

EXISTING FOOTPATH	
PROPOSED FOOTPATH OR PROPOSED FOOTPATH IMPROVEMENT AS REQUIRED	
PROPOSED GRASS VERGE/LANDSCAPING	
PROPOSED CARRIAGEWAY REALIGNMENT & RESURFACING	
PROPOSED CAR PARKING	
PROPOSED SHARED AREA	
EXISTING SHARED AREA	
EXISTING SHARED STREET TO BE RESURFACED	
SHARED STREET (NEW ROAD MARKINGS ONLY)	
TRAIN TRACKS	
PROPOSED DEVELOPMENT AREA	
PROPOSED TRAIL FINISHED LEVELS	$\pm 0.00m$ OD
SPECIAL PROTECTION AREAS	
SPECIAL AREAS OF CONSERVATION	

Revision	Description	Initials	Date

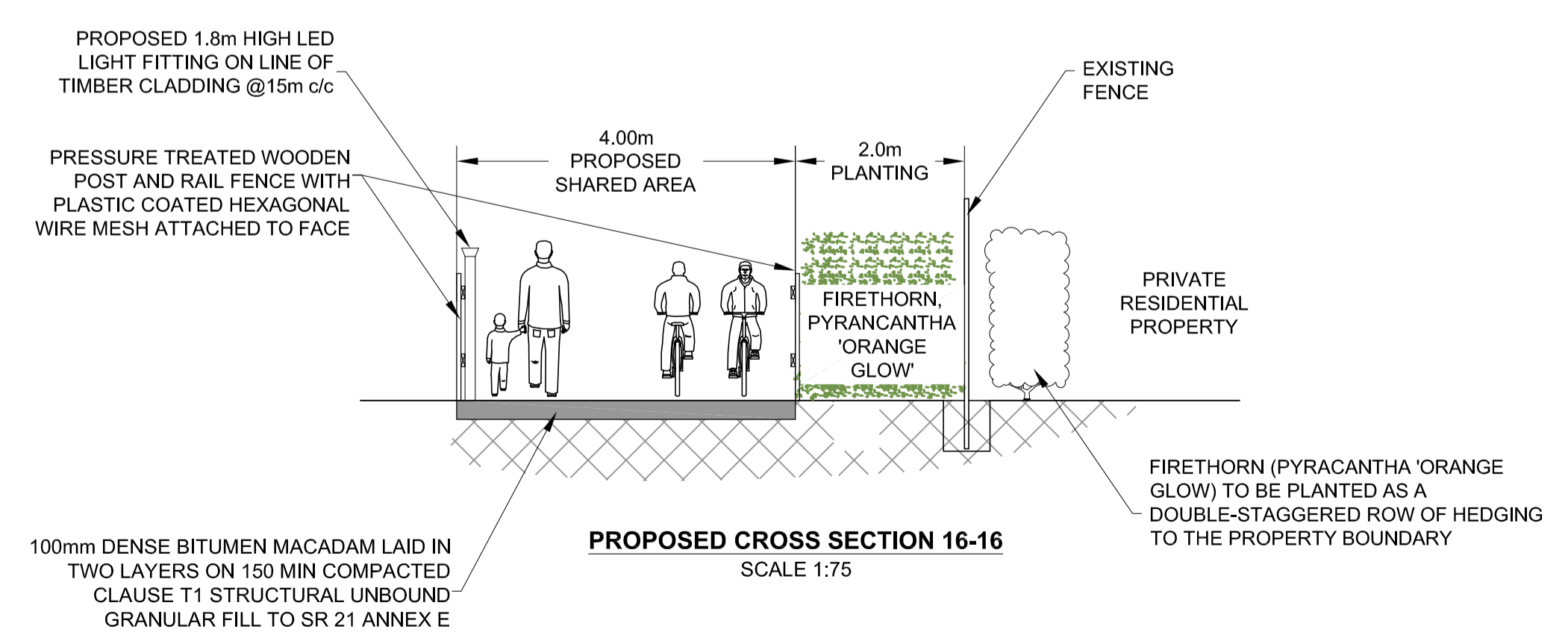
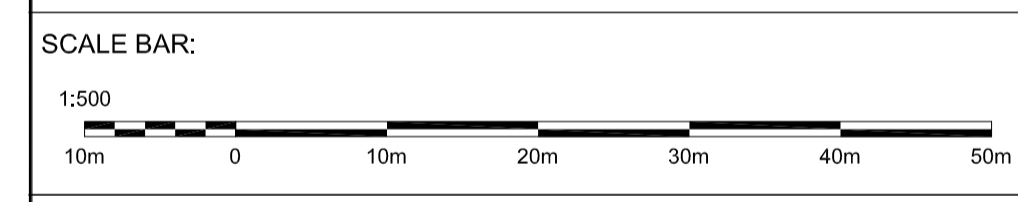
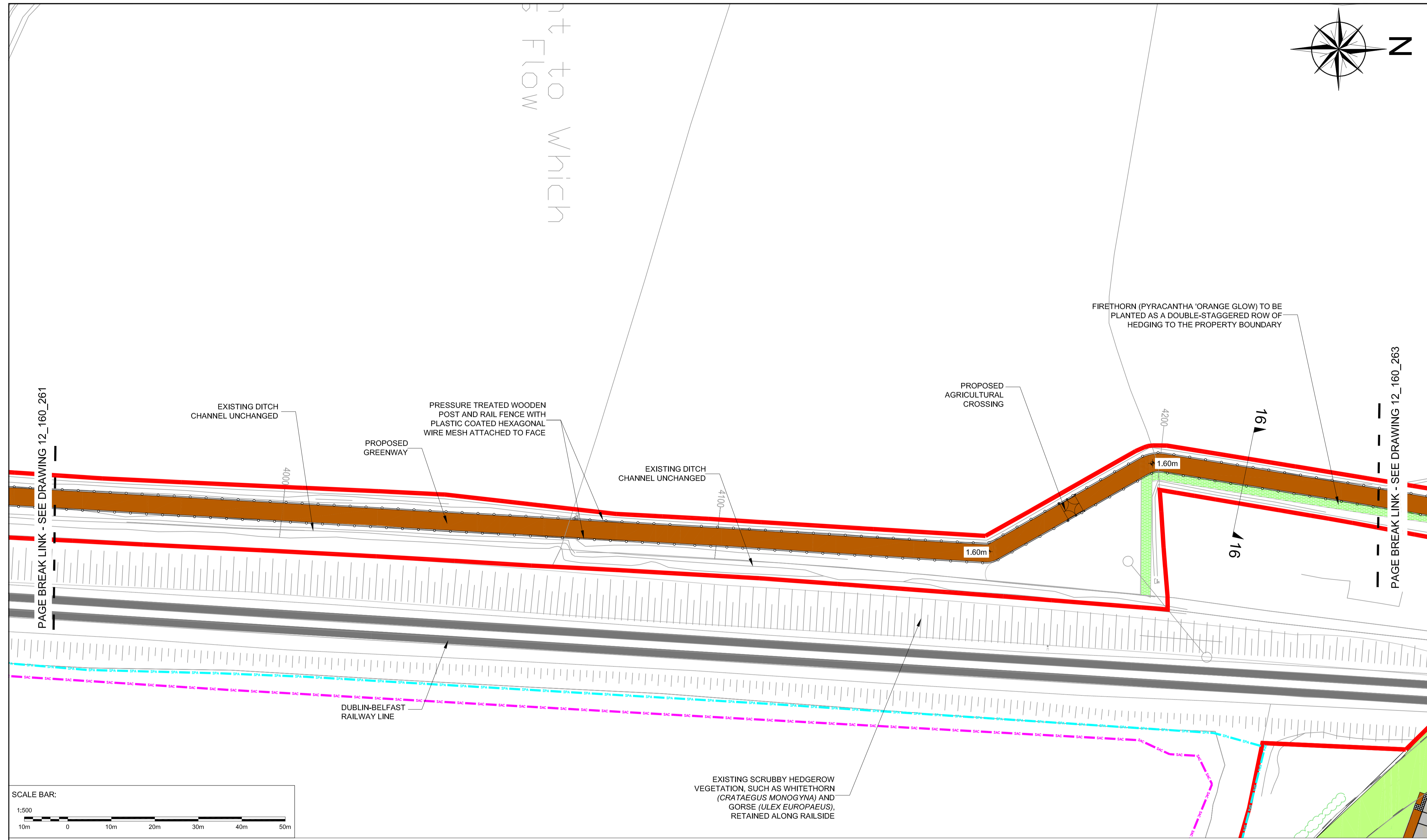

**NOTES:**  
ALL TOPSOIL TO BE REUSED ON SITE.  
TRAIL TO BE LAID WITH A 1/40 CROSS FALL TO ALLOW SURFACE WATER TO NATURALLY DRAIN INTO THE SURROUNDING LANDS.



An Roinn um Pleanáil agus  
Infrastruchtúr Straitéiseach  
Planning and Strategic  
Infrastructure Department

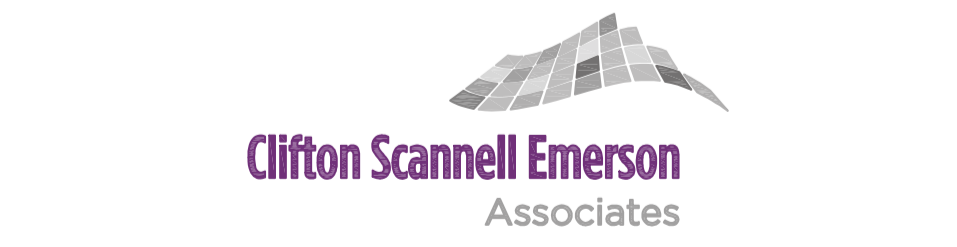

Project	Broadmeadow Way		
Dwg. Title	Overall Surface Layout (Sheet 11 of 17)		
Drawn By	AMS	Date	April 2019
Checked by	PD	Scale	1:500 @ A1
Dwg. No.	12_160_262		1:1000 @ A3